

# Weekly Report

2018-07-09

Kim, Hanbeom

# 1. SQUID Test Probe Improvement

## Adapter PCB (Printed Circuit Board) Design

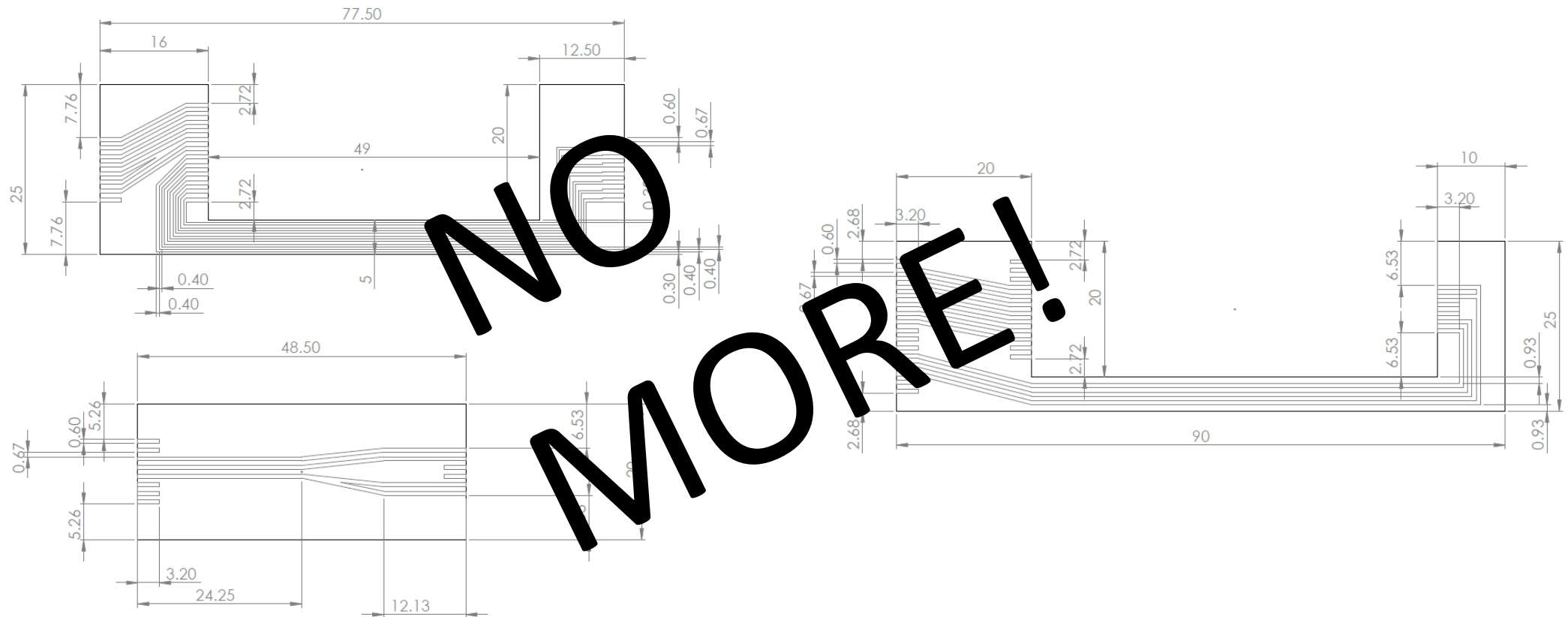

# 1. SQUID Chip Test Probe Improvement

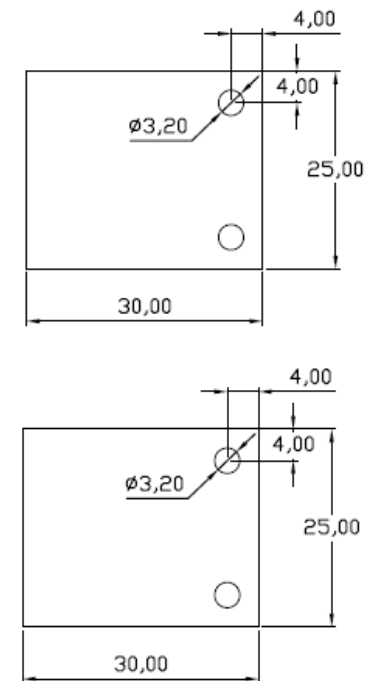
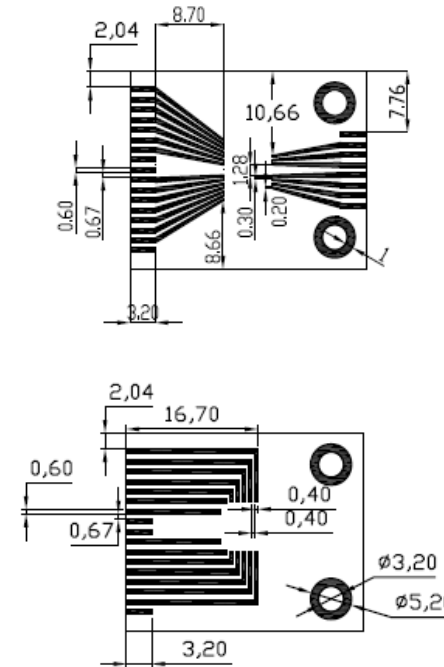

- Probe redesign & Build new chip boards
  - 3 channels for each probe
  - One chip board for 2 SQUID & the other for 1 SQUID

## 2. Crystal holder development

---

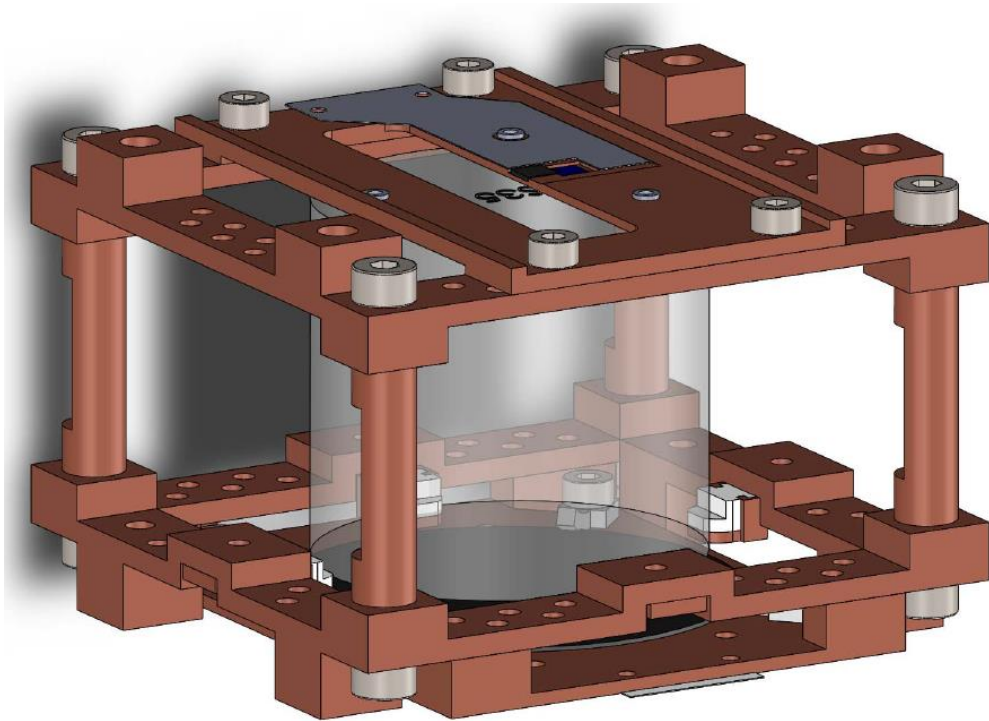

- The previous design used in the AMoRE-pilot
- The copper part of the holder produces background due to minor isotopes
- To plan to reduce the copper mass

## 2. Crystal holder development

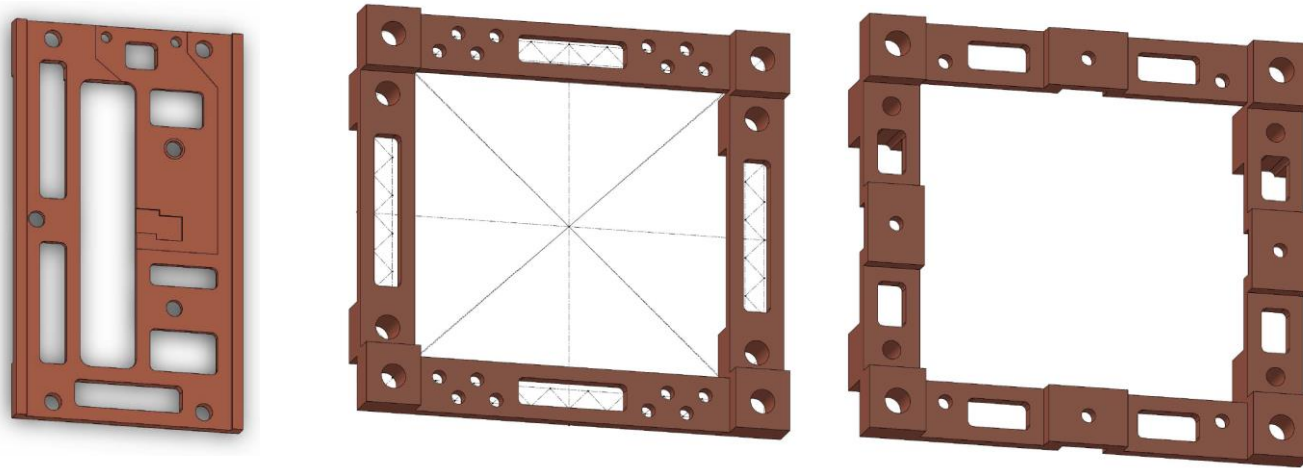

- Each part loses 5~20% of its mass.
- <10 % of mass is reduced totally.

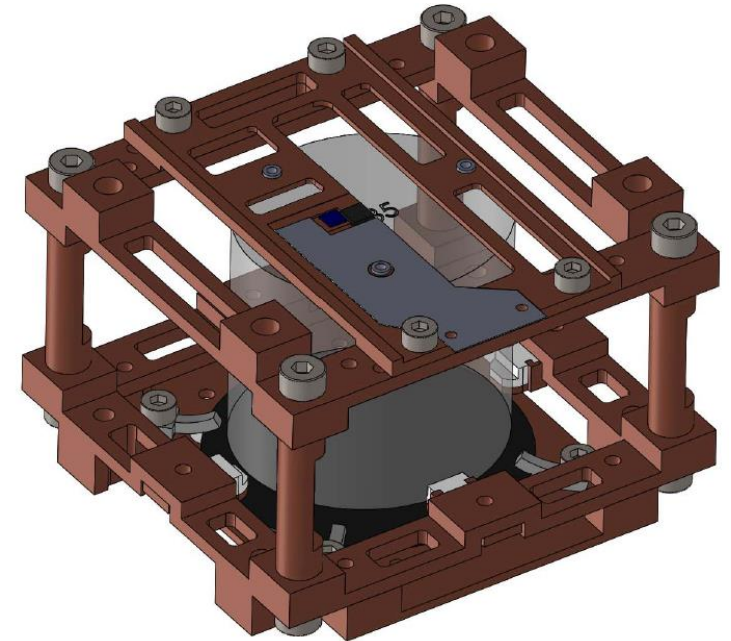

## 2. Crystal holder development

---

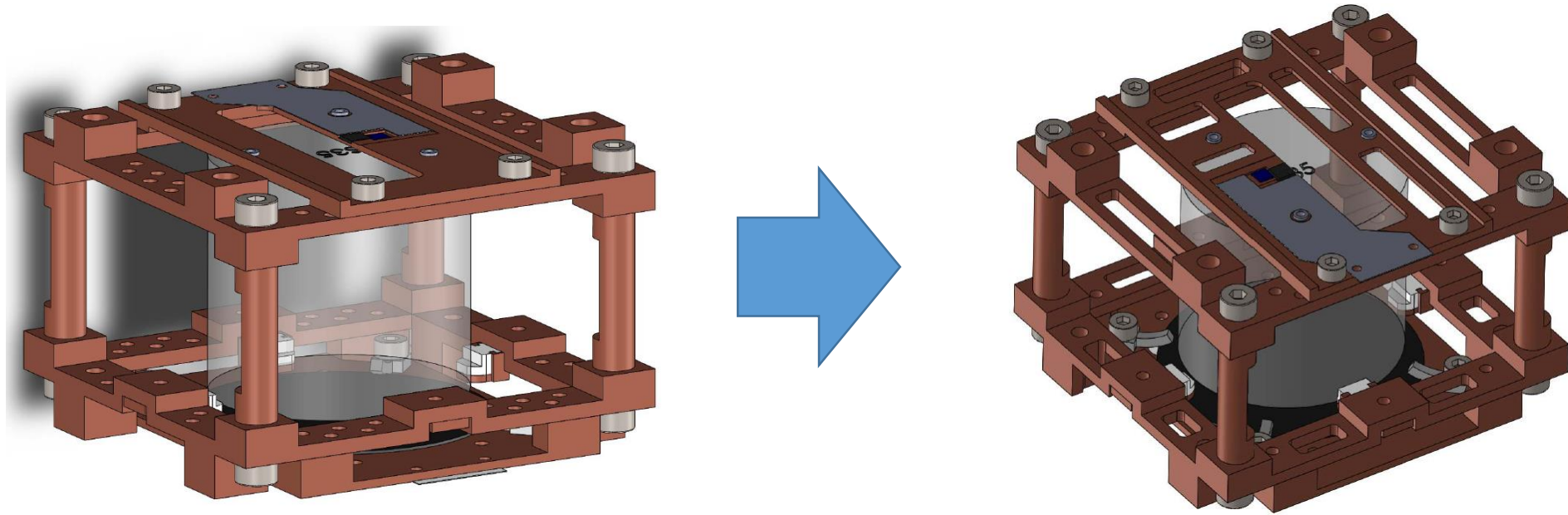

- <10 % seems too small.
- Is the new design is strong enough to bear the weight of crystal and itself?
  - The sample is ordered in the last week.