



- To design devices, elements
- Start with the built-in tutorial

Solidworks: Practice

- LEGO SPEED CHAMPION 75879
- Scuderia Ferrari SF16-H



Solidworks: Practice

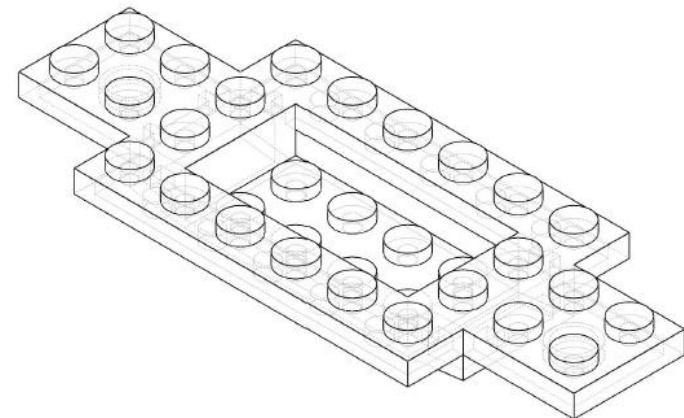
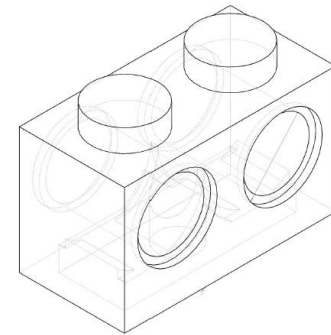
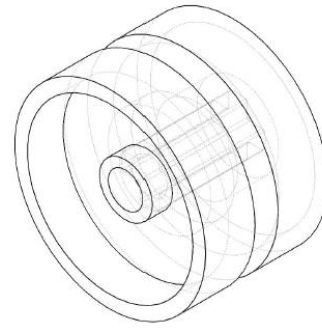
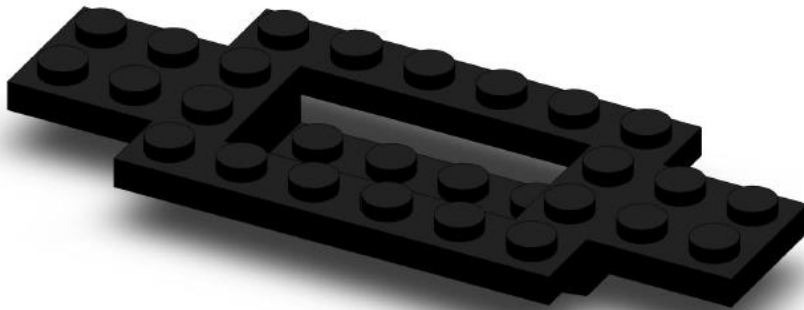
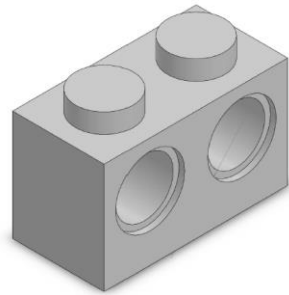

Solidworks: Practice

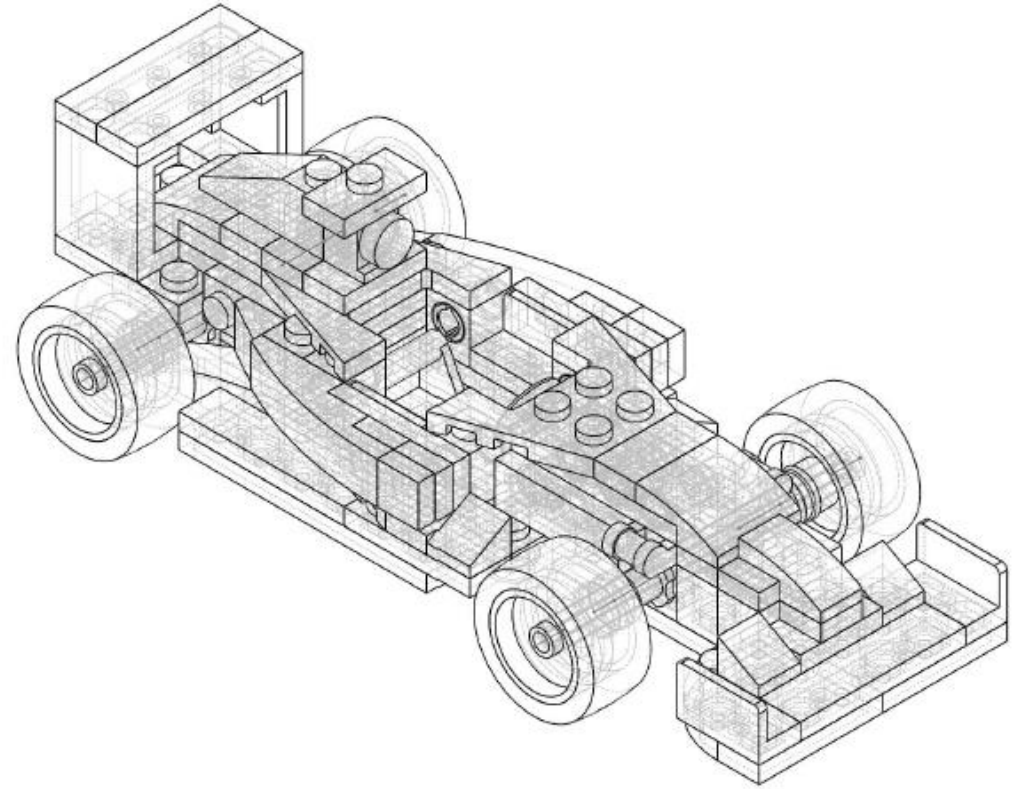
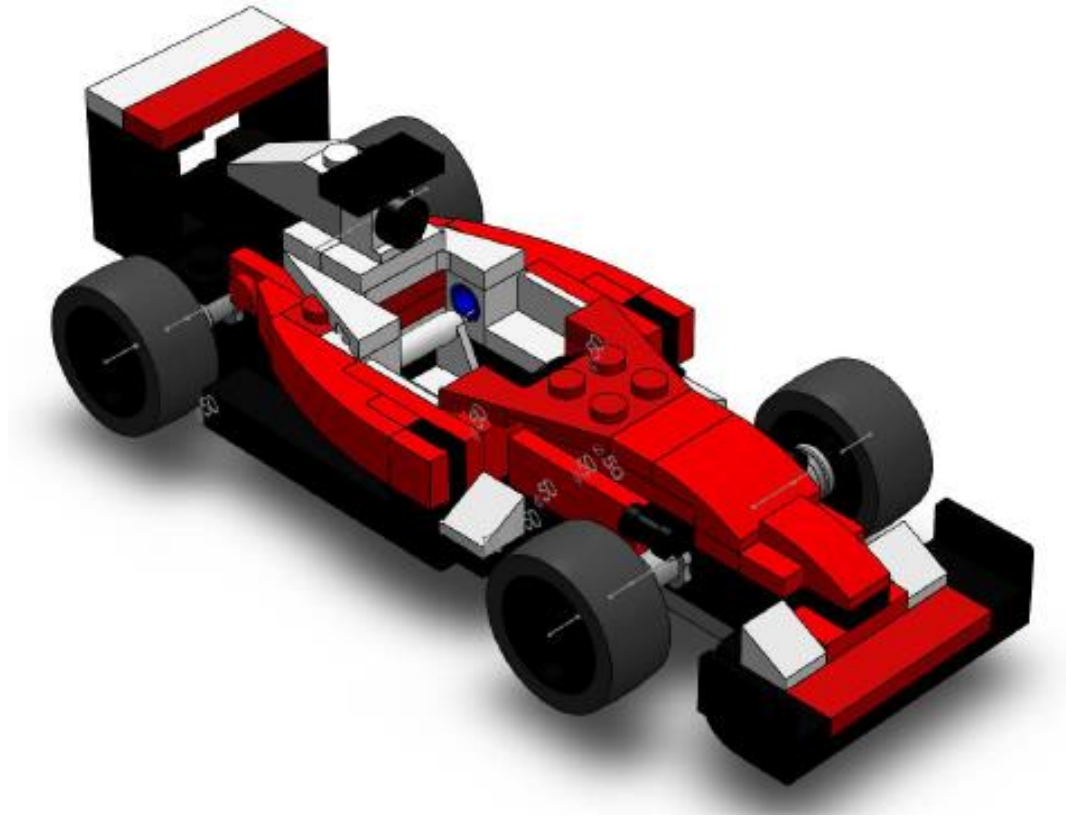

Solidworks: Practice

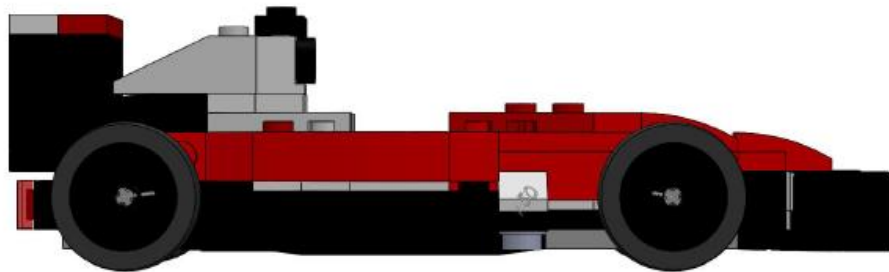
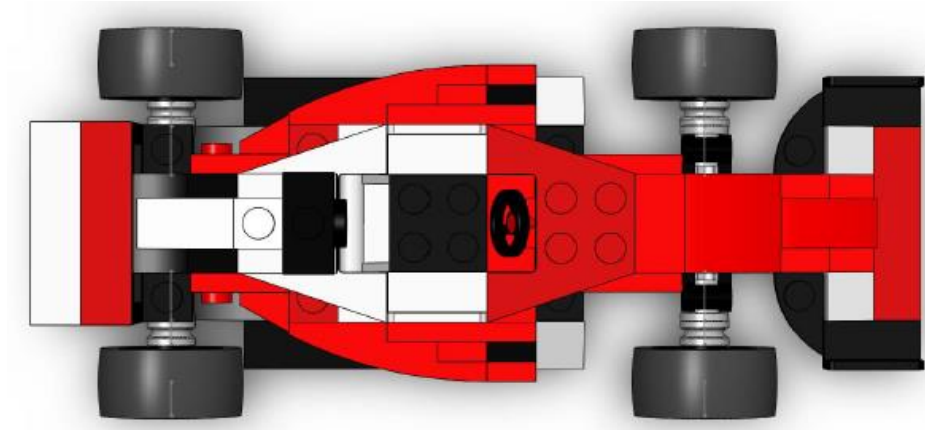

- Time: ~ 3 days
- The tolerance was taken into an account.
- Not exactly same as the real model

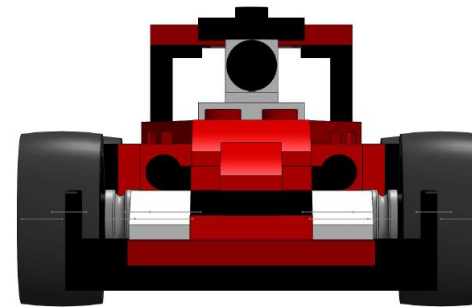

New study: Matlab



- Mainly used here(KT1) rather than others(root, ...)
- For signal analysis

New study: Matlab

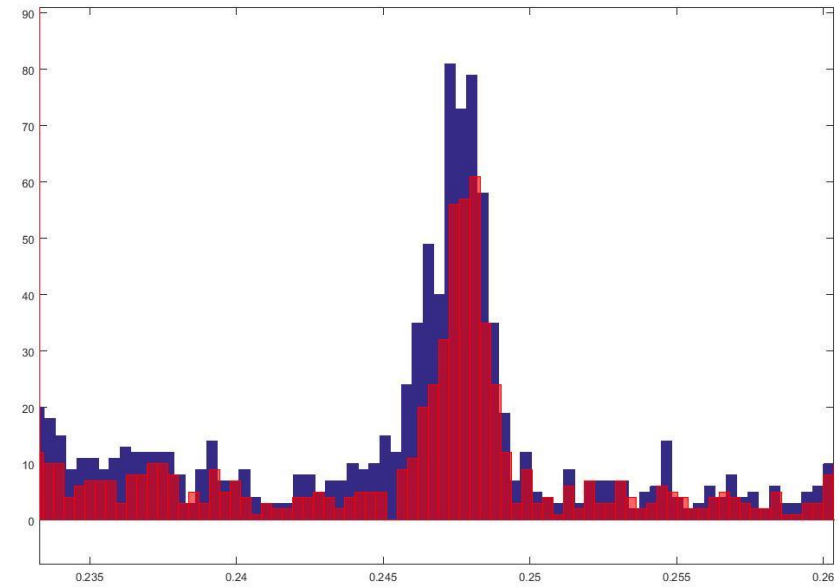
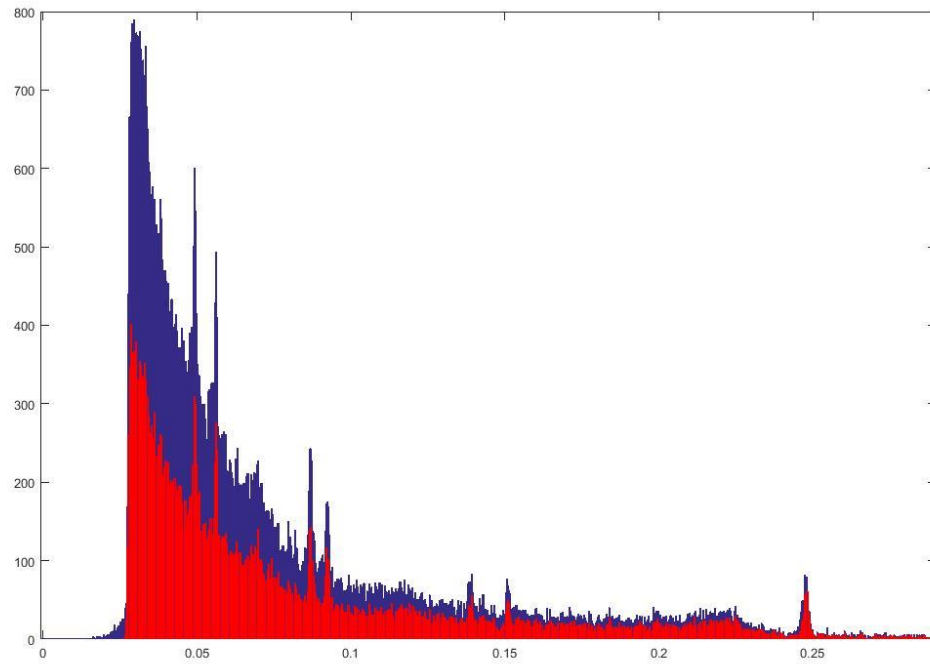

New study: Matlab

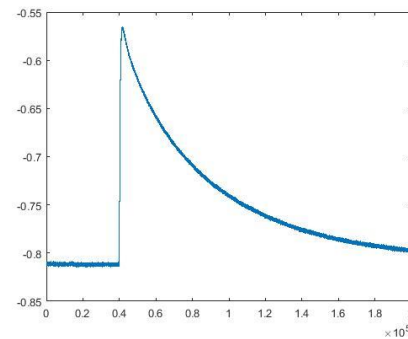
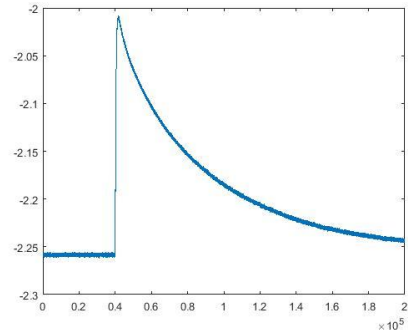

⋮

(

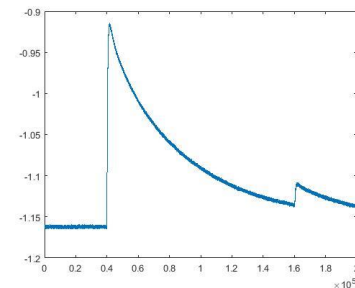

????)

